

WV 01 Ancorante ad elica autoperforante in nylon, per fissaggi su pannelli isolanti, testa $\varnothing 25$ mm

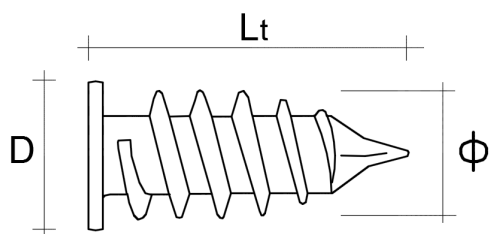

SCHEDA TECNICA



$\varnothing \times l_t$	diametro ancorante x lunghezza ancorante
M	diametro vite utilizzabile
D	diametro testa

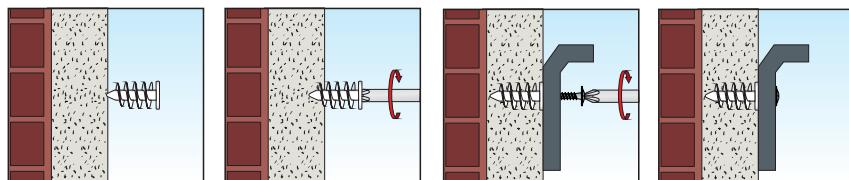

DATI TECNICI E RISULTATI DI PROVA SU WV 01

Codice Articolo	Misura Ancorante $\varnothing \times l_t$ (mm)	M (mm)	D (mm)	Carico massimo consigliato (kg)
WV 01 23 050	23 x 50	3,5 ÷ 4,5	25	60

WV 01 Natural white nylon self drilling helix anchor, for fixing on insulation panels, head diameter 25 mm



TECHNICAL DATA SHEET

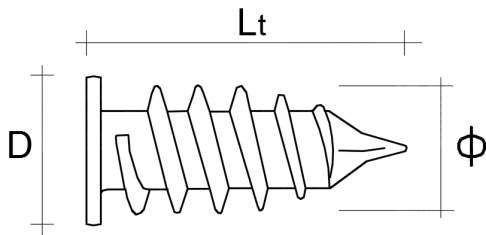

$\emptyset \times l_t$ anchor diameter x anchor length

M usable screw diameter

D head diameter

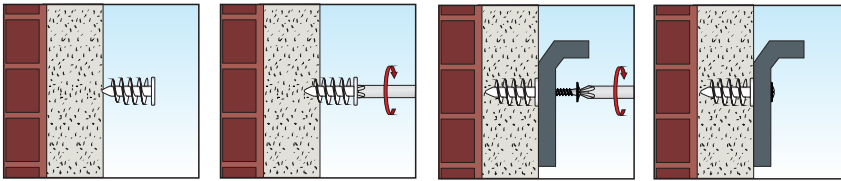

TECHNICAL DATA AND TEST REPORT ON **WV 01**

Item Code	Anchor Size $\emptyset \times l_t$ (mm)	M (mm)	D (mm)	Maximum suggest load (kg)
WV 01 23 050	23 x 50	3,5 ÷ 4,5	25	60