

WS 01 Ancorante ad elica autoperforante in nylon, tipo rinforzato, per fissaggi su pannelli isolanti, testa Ø33 mm

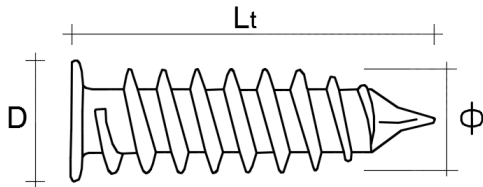

SCHEDA TECNICA



$\varnothing \times l_t$ diametro ancorante x lunghezza ancorante

M diametro vite utilizzabile

D diametro testa

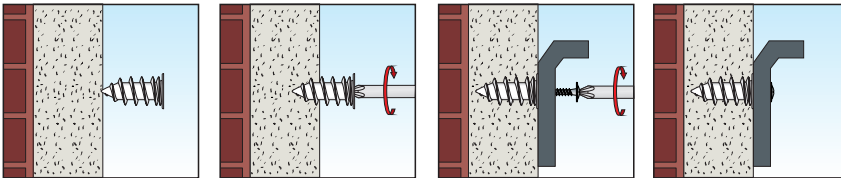

DATI TECNICI E RISULTATI DI PROVA SU **WS 01**

Codice Articolo	Misura Ancorante $\varnothing \times l_t$ (mm)	M (mm)	D (mm)	Carico massimo consigliato (kg)
WS 01 27 058	27 x 58	4 ÷ 6	35	70
WS 01 27 090	27 x 90	8 ÷ 10		100

WS 01 Natural white nylon self drilling helix anchor heavy type, for fixing on insulation panels, head diameter 33 mm



TECHNICAL DATA SHEET

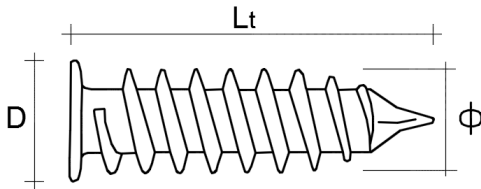

$\emptyset \times l_t$ anchor diameter x anchor length

M usable screw diameter

D head diameter

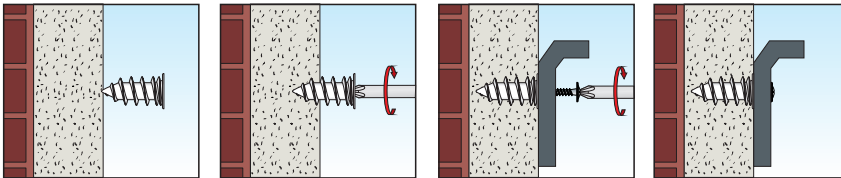

TECHNICAL DATA AND TEST REPORT ON **WS 01**

Item Code	Anchor Size $\emptyset \times l_t$ (mm)	M (mm)	D (mm)	Maximum suggest load (kg)
WS 01 27 058	27 x 58	4 ÷ 6	35	70
WS 01 27 090	27 x 90	8 ÷ 10		100