

ZJ 71 Ancorante con lamierino speciale, dado e rondella, in acciaio INOX A4 (AISI 316)

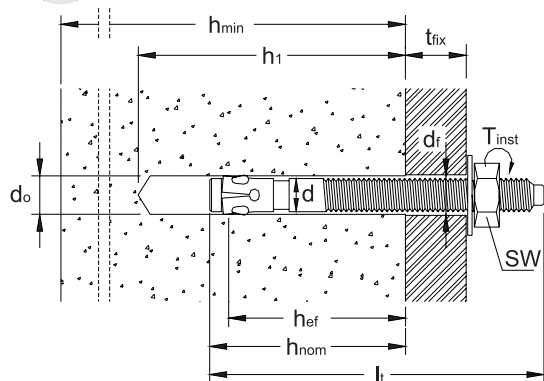

SCHEDA TECNICA



$d_{nom} \times l_t$	diámetro externo ancorante x longitud ancorante
M	diámetro parte filetada
t_{fix}	espesor máximo fijable
d_o	diámetro del foro
h_1	profundidad del foro
h_{min}	espesor del material de soporte
h_{nom}	profundidad de inserimento
h_{ef}	profundidad efectiva de anclaje
d_f	diámetro del foro nell'elemento da fissare
T_{inst}	coppia di serraggio raccomandata
SW	misura chiave
c_{min}	minima distanza dal bordo consentita
s_{min}	minimo interasse consentito
c_{cr}	distanza dal bordo che assicura la trasmissione della resistenza caratteristica di un ancoraggio singolo
s_{cr}	interasse tra ancoraggi in gruppo tale da assicurare la trasmissione della resistenza caratteristica di un ancoraggio singolo

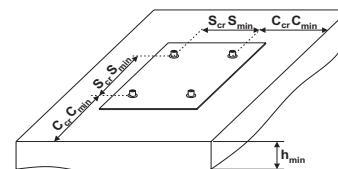
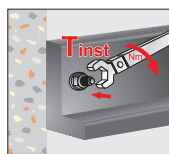
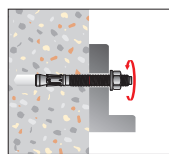
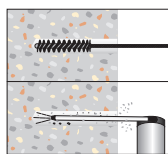
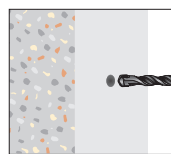

DATI TECNICI E RISULTATI DI PROVA SU ANCORANTI ZJ 71 IN CALCESTRUZZO NON FESSURATO C20/25

Codice Articolo	Misura Ancorante $d_{nom} \times l_t$ (mm)	t_{fix} (mm)	d_o (mm)	h_1 (mm)	h_{min} (mm)	h_{nom} (mm)	h_{ef} (mm)	d_f (mm)	T_{inst} (Nm)	SW (mm)	c_{min} (mm)	s_{min} (mm)	c_{cr} (mm)	s_{cr} (mm)	CARICO CARATTERISTICO (kN)	
															ESTRAZIONE	TAGLIO
Ø 6																
ZJ 71 06 060	6 x 60	2	6	55	100	49,50	40	7	7	10	35	35	60	120	5,75	4,50
ZJ 71 06 080	6 x 80	22														

i Per i dati non inseriti in tabella rivolgersi al Laboratorio Tecfi

In tabella sono indicati i CARICHI CARATTERISTICI per prove effettuate su calcestruzzo C20/25 non fessurato senza influenza del bordo e/o dell' interasse (valori di estrazione e taglio in kN: 1kN = 100Kg).

ZJ 71 A4 (AISI 316) stainless steel wedge anchor, with nut and washer



 TECHNICAL DATA SHEET

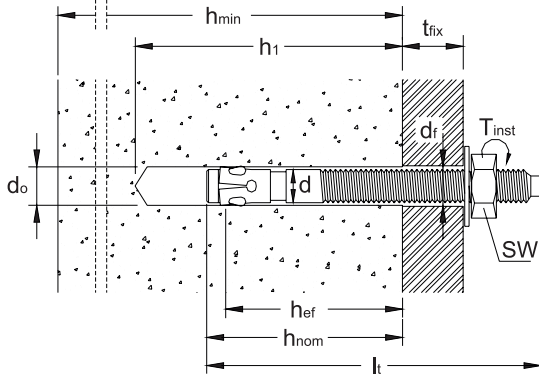

$d_{nom} \times l_t$	anchor diameter x anchor length
M	screw diameter
t_{fix}	maximum thickness of fixture
d_o	drill hole diameter
h_1	depth of drill hole
h_{min}	thickness of concrete member
h_{nom}	overall anchor embedment depth
h_{ef}	effective anchorage depth
d_f	diameter of clearance hole in the fixture
T_{inst}	required torque moment
SW	wrench size
c_{min}	minimum allowable edge distance
s_{min}	minimum allowable spacing
c_{cr}	edge distance for ensuring the transmission of the characteristic resistance of a single anchor
s_{cr}	spacing for ensuring the transmission of the characteristic resistance of a single anchor

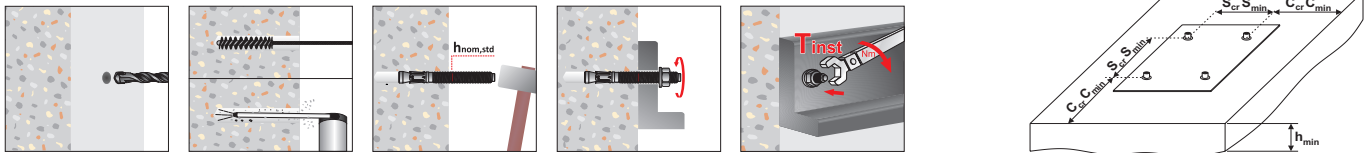

TECHNICAL DATA AND TEST REPORT OF ZJ 71 ANCHORS IN NON-CRACKED CONCRETE C20/25

Item Code	Anchor Size $d_{nom} \times l_t$ (mm)	t_{fix} (mm)	d_o (mm)	h_1 (mm)	h_{min} (mm)	h_{nom} (mm)	h_{ef} (mm)	d_f (mm)	T_{inst} (Nm)	SW (mm)	c_{min} (mm)	s_{min} (mm)	c_{cr} (mm)	s_{cr} (mm)	CHARACTERISTIC LOADS (kN)	
															PULL OUT	SHEAR
Ø 6																
ZJ 71 06 060	6 x 60	2	6	55	100	49,50	40	7	7	10	35	35	60	120	5,75	4,50
ZJ 71 06 080	6 x 80	22														

 For all specification not included in the table, please contact Tecfi Lab

Pull-out and shear showed in the table are CHARACTERISTIC LOADS from tests run on non-cracked concrete C20/25 without edge and spacing effect (Pull-out and shear loads are in kN: 1kN = 100Kg).